

CanadaDocks™



Where *fun* on the water *begins!*



Chain Retainer Installation

Read this manual and related assembly instructions before attempting to assemble the parts enclosed to ensure that your new CanadaDocks System is assembled safely and correctly.

INCLUDED IN KIT:

CR1



2x

NL38



6x

CB15S



2x

TOOLS REQUIRED:

9/16" SOCKET WITH RATCHET TO
SUIT OR 9/16" WRENCH

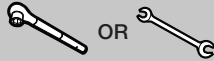

OR

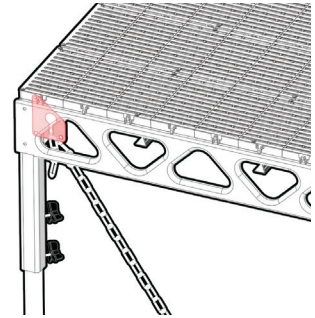
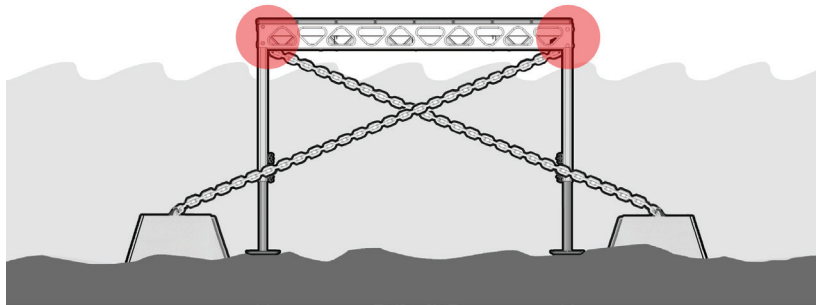

Chain retainers are used to connect anchor chains to a standing dock. See images above to see the locations for placement.

PLEASE NOTE: View anchoring instructions for any further information on anchor installation.

1

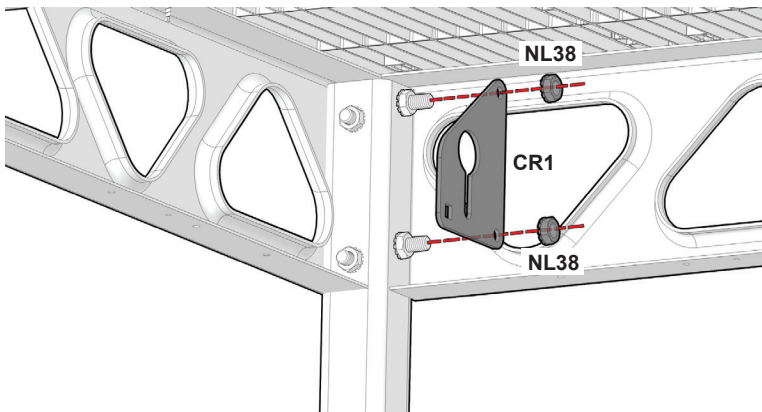

CR1



1x

NL38



2x

Place chain retainer (**CR1**) plate over the top of the existing bolts on the corner legs. Fasten with nuts (**NL38**). Follow **STEP 1** for any chain retainers to be added to your dock system.

2

Connection the chain to the chain retainer.

CB15S



1x

NL38

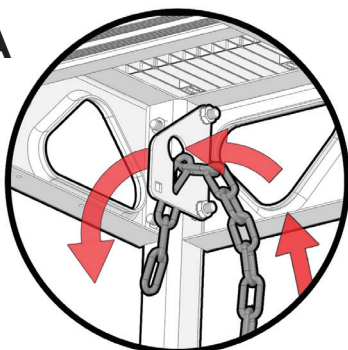
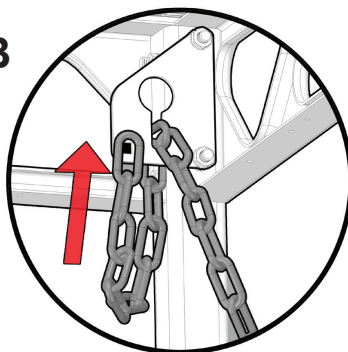
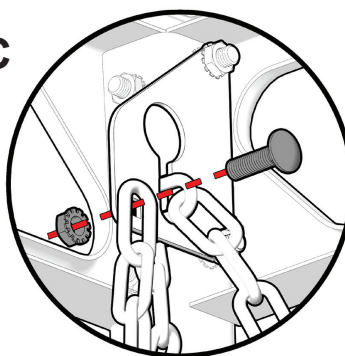

1x

A**B****C**

Feed the chain through the chain retainer, keeping the chain link tight.

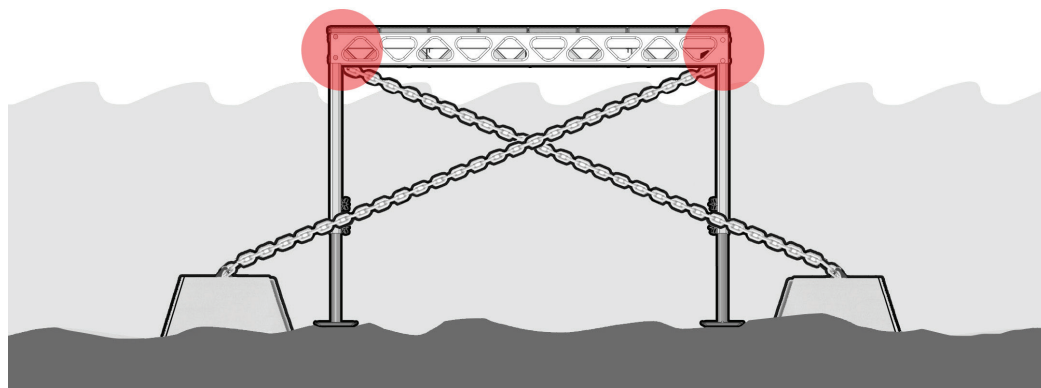
3

Follow **STEPS 1-2** for The **second** Chain retainer on the opposite side.

Where *fun* on the water *begins!*

Please leave us a **Google review**



We'd love to hear from you and see your photos!



Phone

705.434.0359
1.877.434.0359



Email

info@canadadocks.ca



Address

3690 Adjala-Tecumseth Tl,
Beeton ON L0G 1A0

CanadaDocks.ca

